

KVM Extender

Dual 4K30 DisplayPort KVM Extender with 2-Way Audio, RS-232, IR and USB 2.0 Ext., Dual Duplex SC, MMF 1Km

Model: IPXF-DD430-DSC1K

PRODUCT OVERVIEW



Dual Display, DP KVM Extender over Fiber, Dual SC Multimode, 4K30@1000M, USB 2.0, Two-Way Audio/Serial/IR Extension, Audio Embedder/Extractor Functions

The IPXF-DD430-DSC1K, Dual DP KVM Extender, consists of a transmitter (computer unit) and a receiver (console unit) and extends dual DisplayPort, two-way audio, USB 2.0, IR, and RS-232 signals up to 1000 meters over two multimode fiber optic cables. Unique audio embedder and audio extractor functions are especially designed for video editing and content creation. Dual DisplayPort supports both duplicate and extend modes, providing multiple monitor setups to extend your desktop and expand the work area across displays.

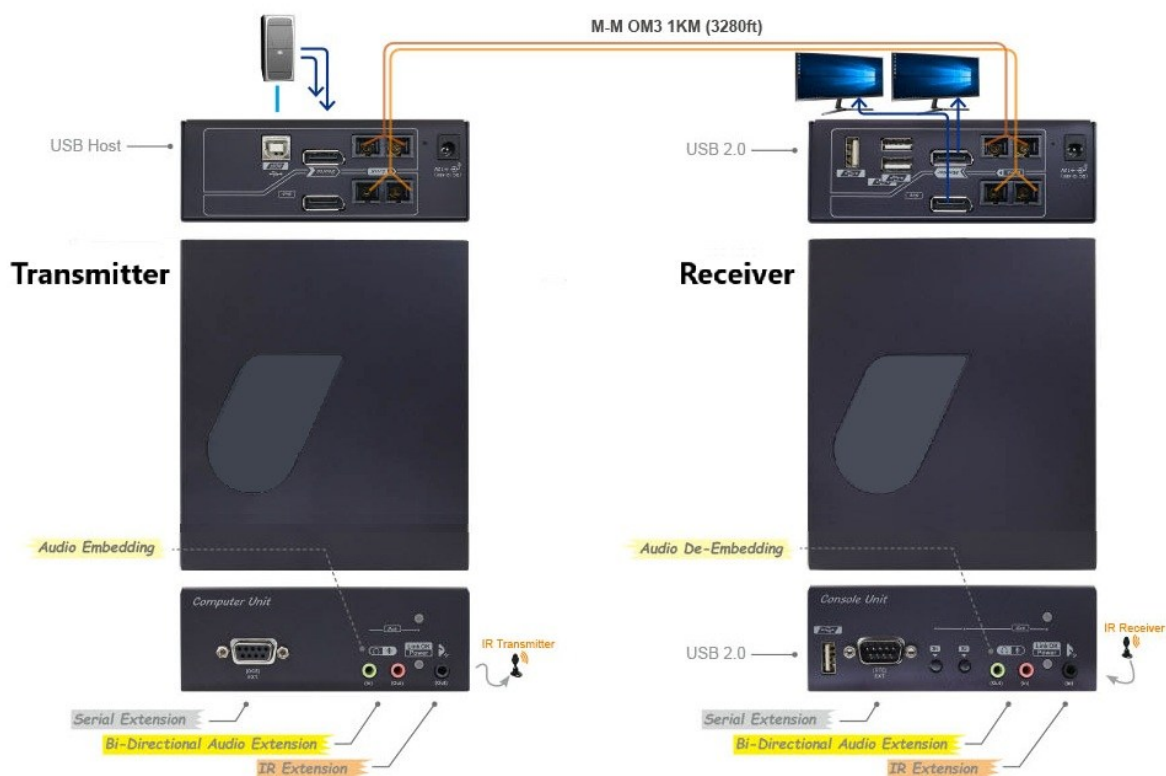

KVM Extender

Plug-and-Play USB 2.0 Peripheral Sharing

The receiver unit (Rx) features four USB 2.0 ports, with one located on the front panel and three located on the rear panel, supporting both temporary and permanent USB peripheral connections. No software or driver installation is required, and it supports common operating systems such as Windows, macOS, Chrome OS, and Linux.

Two-Way Audio

The extender unit's bi-directional audio extension function independently transmits audio signals from the transmitter unit to the receiver unit and vice versa. Two-way audio is especially useful in PA systems, particularly in emergency situations, allowing users in the control center and server room to communicate and coordinate remotely.

Unique Audio Embedding / De-Embedding Function

The audio embedder function inserts audio from a 3.5 mm analog stereo audio source into the DisplayPort (DP) signal, while the audio de-embedder function extracts audio from the DP signal to a 3.5 mm stereo audio output. The Dual Display DP KVM Extender allows users to flexibly integrate audio signals to create more informative content, such as adding or removing voice-over audio and background music during video editing.

IR Extension

The IR function supports a full-frequency IR signal range from 38 kHz to 56 kHz. In addition, the distance between the emitter head and the IR port on the unit can be extended to provide a flexible and convenient IR control system installation (maximum 3-meter IR cable, sold separately).

Serial Extension with Selectable Baud Rate Setting

Full-duplex data communication between Tx and Rx provides a cost-effective hardware-based solution. The IPXF-DD430-DSC1K enables remote access and control for RS-232 protocol devices without additional setup or configuration. The RS-232 serial extension is suitable for applications such as digital signage, industrial control, commercial offices, smart classrooms, and smart conference rooms.

KVM Extender

KEY FEATURES

- Allows reliable remote PC access to a dual-monitor computer via two duplex SC multimode fiber cables up to 1 km
- Supports the most popular resolutions for dual DP video up to 4K@30Hz (4:4:4)
- USB 2.0 extension supports most popular USB devices
- IR extension from the console unit to the computer unit
- Serial extension facilitates industrial control
- Front USB ports allow easy access
- Easy baud rate selection via OSD and front panel buttons
- EDID pass-through ensures accurate monitor information communication
- HDCP 1.4 compliance ensures uninterrupted 4K video playback
- Plug-and-play operation; no driver or software required
- Supports Windows, macOS, Linux, and Chrome OS
- Fiber link port provides isolation from EMI and electrical noise
- Smart audio extension (audio auto embed/extract)
- Wide power input range: DC 12–48V

KVM Extender

PRODUCT SPECIFICATIONS

IPXF-DD430-DSC1K	Transmitter	Receiver
Maximum Resolution *	Dual 4096 x 2160@30Hz (4:4:4) Dual 3840 x 2160@30Hz (4:4:4)	
Dual Video Extension	DisplayPort x 2 (In)	DisplayPort x 2 (Out)
USB 2.0 Extension	USB-B x 1	USB-A x 4
Speaker Extension	3.5mm SPK Jack x 1 (In) (Supports Audio Embed)	3.5mm SPK Jack x 1 (Out) (Supports Audio Extract)
Microphone Extension	3.5mm MIC Jack x 1 (Out)	3.5mm MIC Jack x 1 (In)
IR Extension	3.5mm IR Jack x 1 (Out)	3.5mm IR Jack x 1 (In)
Serial Extension (9600 ~ 115200bps)	DB9 x 1 (RS-232 DCE)	DB9 x 1 (RS-232 DTE)
Push Buttons	Reset x 1	Reset x 1 Baud Rate Button x 2
LED Indicator	Power/Connection Status x 2	Power/Connection Status x 2
HDCP Compliance	HDCP 1.4	
Link Port (1.25Gbps, 850nm)	Duplex SC x 2 (50/125µm, OM3)	Duplex SC x 2 (50/125µm, OM3)
Maximum Distance	1Km (SC, Multimode)	
Power Supply	DC 12V ~ 48V	DC 12V ~ 48V
Operating Environment **	0 ~ 40°C, Humidity < 80%	
Storage Temperature	-20 ~ 60°C	
Material	Aluminium	
H x W x D (mm)	44 x 122 x 140	44 x 122 x 140
Weight (g)	400	450

* The extender supports most popular resolutions. Monitors with special EDIDs may not work properly.

** When installed in a sealed enclosure, proper airflow should be provided to ensure proper operating temperature.

KVM Extender

CONNECTION DIAGRAM

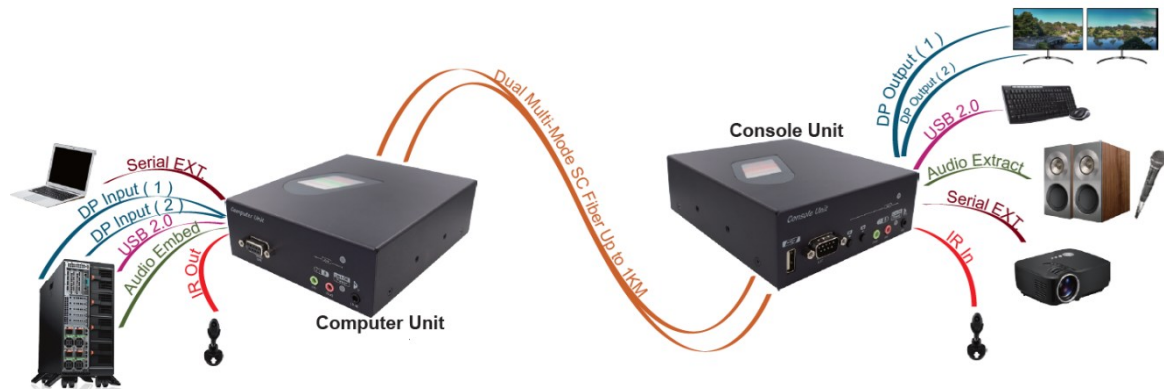

Connection Interfaces of the Transmitter and Receiver:

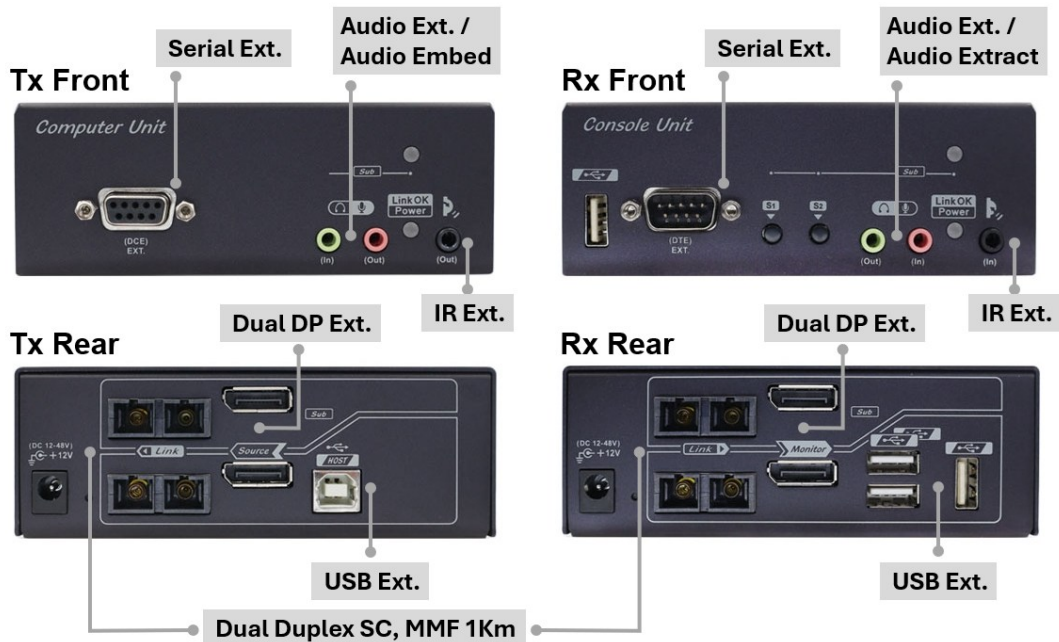

KVM Extender

PACKAGE CONTENTS

- 1 × Transmitter Unit
- 1 × Receiver Unit
- 2 × Power Adapter
- 2 × Foot Pad Sets
- 1 × User Manual
- (Optional) 1 × IR Extension Kit

WARRANTY

- Standard 1-Year Limited Warranty, unless otherwise specified by Sales.
- Optional Advance Replacement Warranty is available upon request

ORDERING INFORMATION

Part Number	Descriptions
IPXF-DD430-DSC1K	Dual 4K30 DisplayPort KVM Extender with 2-Way Audio, RS-232, IR and USB 2.0 Extension, Dual Duplex SC, MMF, 1Km

CONTACT INFORMATION

For more information, please visit our website or contact our customer service team:

- **Website:** www.dsgio.com
- **Email:** sales.apac@dsgio.com

DISCLAIMER

DSGio shall not be liable for any damages, including punitive, consequential, or cost of cover damages, arising from any errors in the product information or specifications provided in this document. This document is subject to revision by DSGio at any time without prior notice.